

3DSIMO - BASIC 2

INSTRUCTION MANUAL

set contains

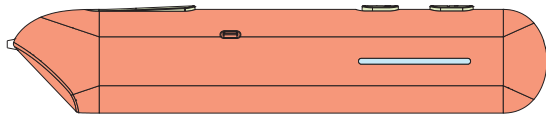

3DSIMO BASIC 2



service key

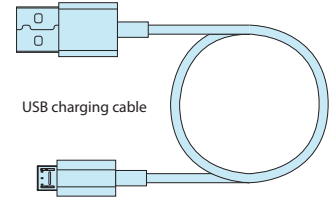

USB charging cable

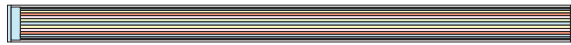

PCL material

Charge your device before first use

controls & elements

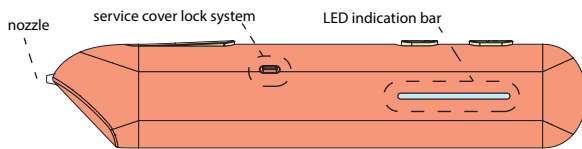
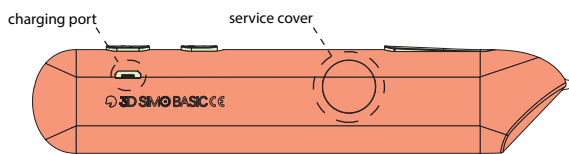
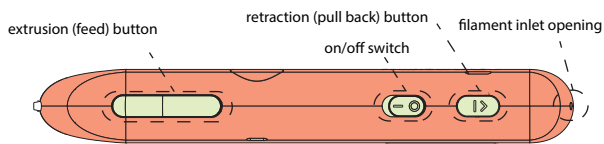

service cover acces

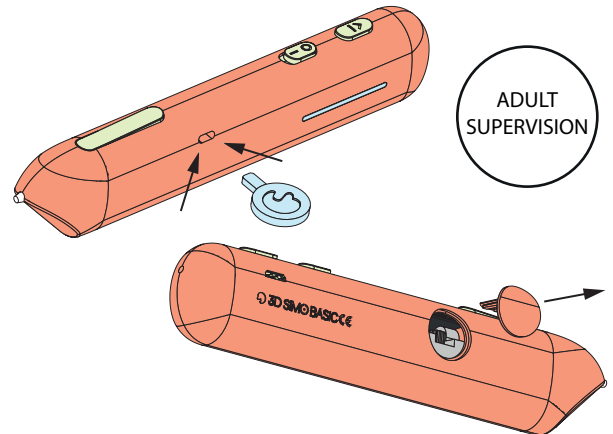

You can easily maintain your 3DSIMO Basic 2
 1. Open service cover with service key.
 2. Remove all grinded material and dust, then put cover back onto Basic 2.

insertion of material

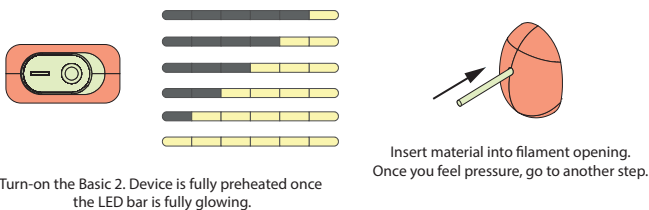

hold extrusion button and check if your material is feeded into the nozzle.
 After a while, you will see material going out of the nozzle.

ejection of material

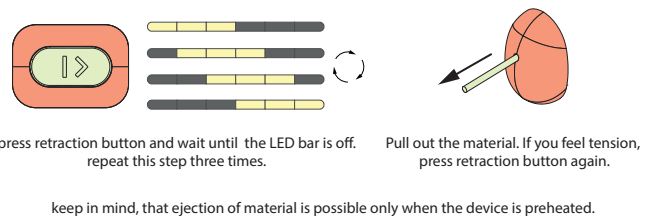

device charging

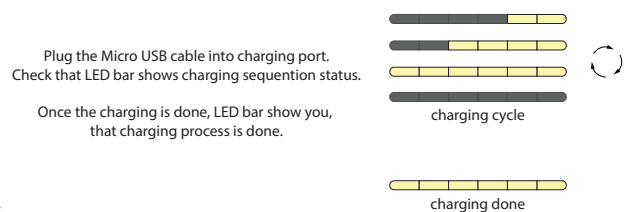

charging cycle

charging done